

# BACK END DRIVE MOTOR & BRACKET ASSEMBLY

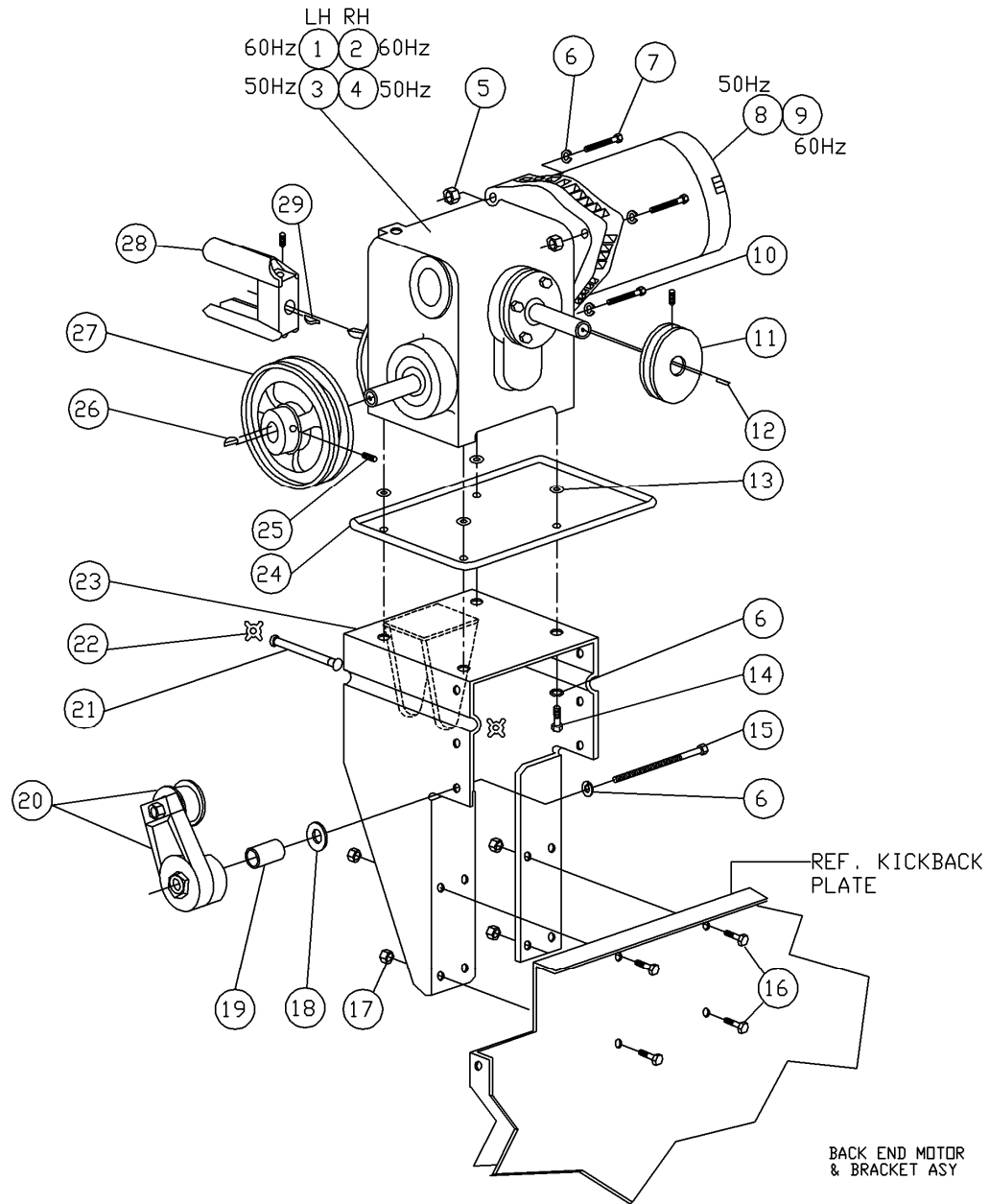



## BACK END DRIVE MOTOR & BRACKET ASSEMBLY

ITEM	QTY	PART #	DESCRIPTION
1	1	088-004-502	GEARBOX, EVEN MACHINE, 60 Hz
2	1	088-004-501	GEARBOX, ODD MACHINE, 60 Hz
3	1	088-004-507	GEARBOX, EVEN MACHINE, 50 Hz
4	1	088-004-506	GEARBOX, ODD MACHINE, 50 Hz
5	2	839-665-002	NUT, FLEX LOCK, 3/8 - 16
6	8	951-164-002	WASHER, SPLIT LOCK, 3/8
7	2	809-865-325	SCREW, HEX, 3/8 - 16 X 2
8	1	090-007-310	MOTOR, 50 Hz
9	1	090-003-766	MOTOR, 60 Hz
10	1	809-865-245	SCREW, HEX, 3/8 - 16 X 1-1/2
11	1	000-022-172	DRIVE SHEAVE
12	1	907-202-600	KEY, SQUARE, 3/16 X 1-7/8
13	4	000-023-758	GASKET WASHER, 7/8 X 3/8 X 1/32
14	4	809-865-165	SCREW, HEX, 3/8 - 16 X 1
15	1	070-003-221	SCREW, HEX, 3/8 - 16 X 3-1/2
16	4	809-857-125	SCREW, HEX, 5/16 - 18 X 3/4
17	4	844-057-002	NUT, STOVER LOCK, 5/16 - 18
18	1	000-021-792	WASHER, FLAT, 7/8 X 13/32 X 1/8
19	1	090-004-519	SPACER
20	1	090-003-508	TENSIONER ASSEMBLY
21	1	000-022-821	PIN
22	2	963-600-002	X-WASHER
23	1	090-003-509	MOTOR MOUNT WELDMENT
24	1	090-004-517	BACK END MOTOR DRIP PAN
25	3	807-358-060	SETSCREW, 5/16 - 24 X 3/8
26	1	907-201-000	KEY, SQUARE, 3/16 X 1-1/4

ITEM	QTY	PART #	DESCRIPTION
27	1	000-023-673	PIN ELEVATOR DRIVE SHEAVE
28	1	090-001-130	DISTRIBUTOR DRIVE HOUSING
29	1	907-000-300	KEY