

# TABLE & RESPOT LINKS

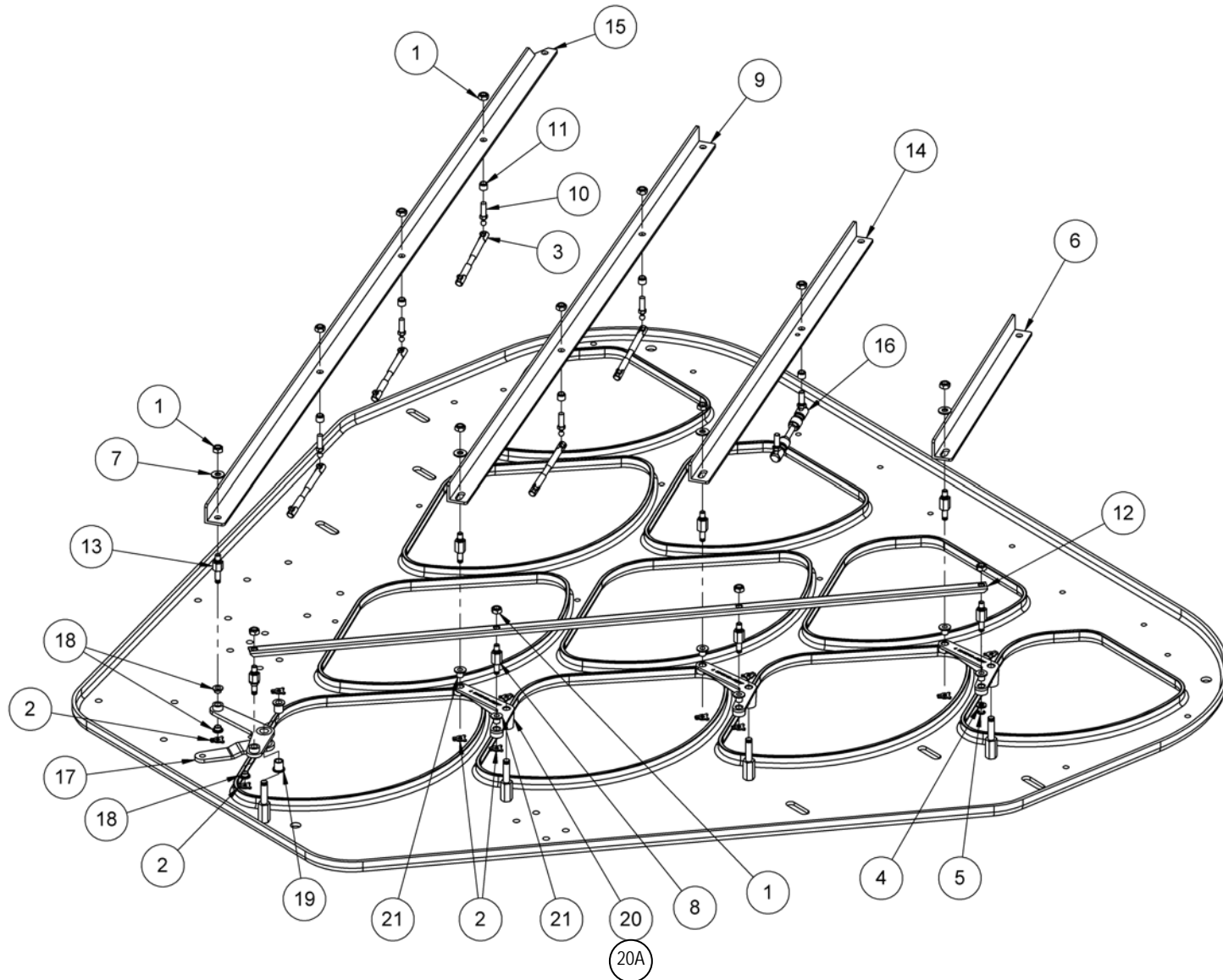



## TABLE & RESPOT LINKS

ITEM	QTY	PART #	DESCRIPTION
1	14	844-049-002	NUT, STOVER LOCK, 1/4 - 20
2	12	963-400-002	X-WASHER
3	6	090-002-020	LINK BODY
4	1	785-502-207	FLAT WASHER
5	1	919-001-450	E-CLIP
6	1	090-005-558	10-PIN LINK
7	3	948-753-102	WASHER, FLAT, 9/32 X 5/8 X 1/16
8	6	090-005-571	PIN, 8-, 9-, & 10-PIN LINKS
9	1	090-005-556	8-PIN LINK
10	5	730-027-019	STUD, BALL HEAD
11	6	070-002-815	SPACER BUSHING
12	1	070-002-671	RESPOT LINK
13	2	090-005-612	PIN, 7-PIN LINK
14	1	090-005-557	9-PIN LINK
15	1	090-005-555	7-PIN LINK
16	1	088-005-532	6-PIN LINK ASSEMBLY
17	1	090-005-607	FRONT LINK CONNECTOR WELDMENT
18	4	070-002-630	FLANGED BEARING, .25 X .32 X .22
19	2	900-205-081	FLANGED BEARIING, .31 X .44 X .50
20	3	070-002-677	LEVER CASTING
20A	3	070-007-623	RESPOT LEVER ASSY (Includes items 20 & 21)
21	6	070-002-653	FLANGED BEARING, .252 X .315 X .38

ITEM	QTY	PART #	DESCRIPTION
------	-----	--------	-------------