

CELL ASSEMBLY - RESPOT

070-007-200

070-006-674

ITEM	PART NUMBER	DESCRIPTION
1	070-007-261	Finger Ass'y. (Finger with items 26 & 27)
2	070-002-792	Frame Respot Weld
3	070-007-194	Stud-Long
4	070-007-195	Stud-Short
5	070-007-196	Bushing
6	070-007-192	Washer
7	070-007-193	Spacer
*8	070-007-617	Stud-Pivot ($\frac{5}{16}$ Dia Shaft)
8a	070-002-654	Stud-Pivot ($\frac{1}{4}$ -Dia Shaft)
**9	070-002-752	Bumper Extrusion
10	844-049-002	Stover Locknut $\frac{1}{4}$ -20 Auto Gr. C.
11	963-400-002	X Washer 9000-12
12	963-200-002	X Washer 9000-8
13	070-007-619	Respot Yoke Ass'y. (With items 14, 17, 18, 19, 22 and 23.)
13a	070-007-621	Respot Yoke Ass'y. for Respot Cell 7 only (With items 19a, 22 & 23)
14	070-002-629	Yoke, Arm Ass'y. (With Item 16)
15	070-002-630	Bushing Yoke
16	933-623-050	Rivet - Yoke
17	070-002-644	Plate - Ass'y. (With Item 15)
18	070-002-646	Arm Ass'y. Respot Yoke (With items 21, 24, and 25)
19	070-007-618	Lever Ass'y. (9 cells) (With item 20 underside and 21)
19a	070-007-620	Lever Ass'y. #7 cell (With item 20 above and 21)
20	070-002-653	Bushing
21	070-002-645	Shaft
22	070-002-649	Spring Yoke Arm
23	070-002-750	Screw
24	070-002-632	Screw, Stop
25	070-002-570	Insert, Ass'y.
26	070-007-197	Insert
27	913-437-100	Spring Pin $\frac{3}{16}$ Dia. x $\frac{5}{8}$ Lg.
28	808-640-141	Screw Soc. Hd. Cap #10-32 x $\frac{7}{8}$
29	808-640-121	Screw Soc. Hd. Cap #10-32 x $\frac{3}{4}$
30	070-007-200	Respot Cell Ass'y. Complete (For Cells 1 thru 6 and 8 thru 10)
31	070-006-674	Respot Cell Ass'y. Complete (For #7 Cell Only)
32	008-100-413	3M Adhesive (EC1300)

*With Item #8 No Bushings Used In Boss Of Item 19.

With Item 8a Bushings Are Used In Boss of Item 19. 070-002-653 Flange Bushing and 070-002-652 Sleeve Bushing.

**Cement Item #9 to Item #2 With Item #32.

ASSEMBLY FOR RESPOT CELL #7 ONLY

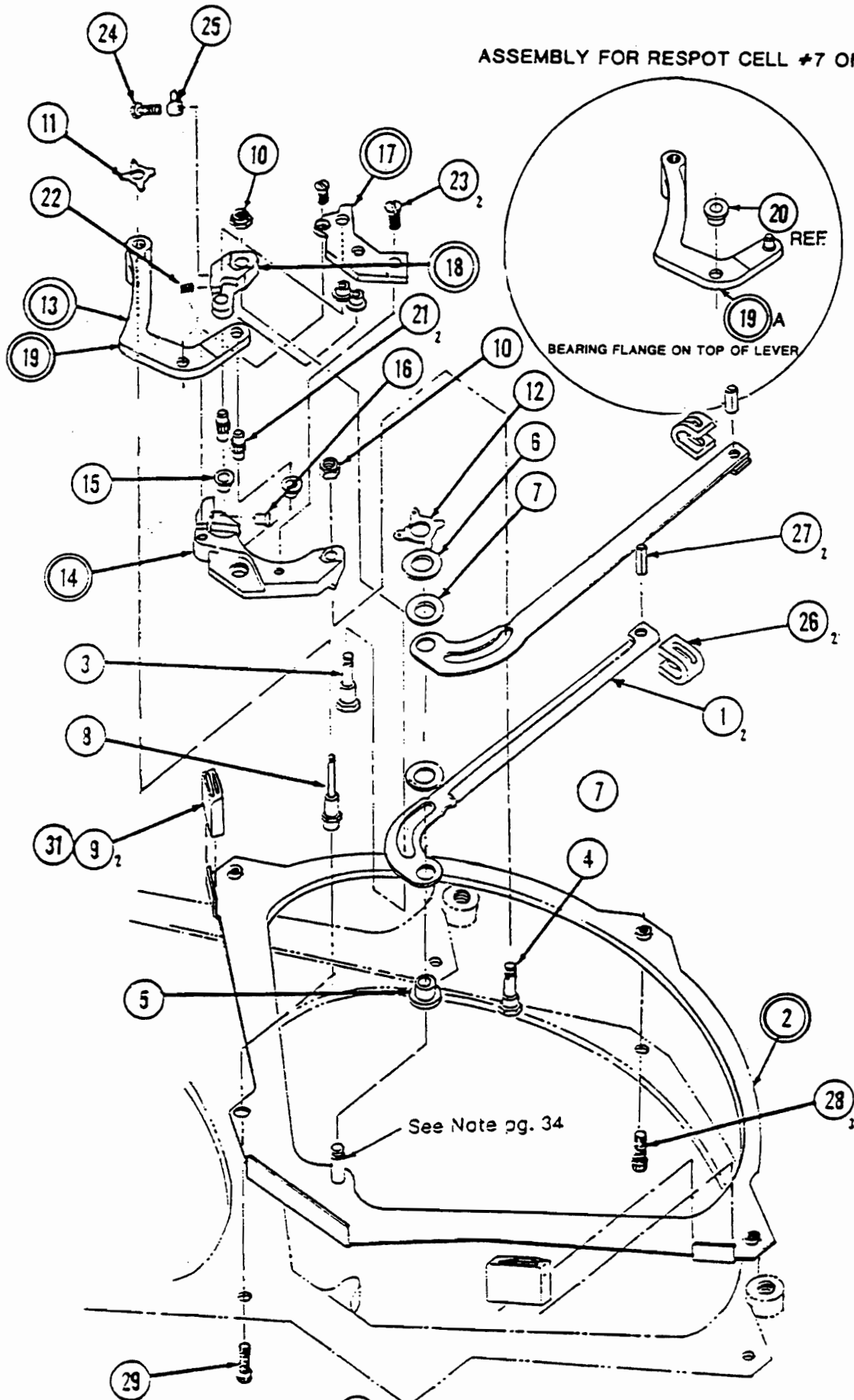

30 070-007-200 RESPOT CELL ASSEMBLY

31 070-006-674 RESPOT CELL NO. 7 ASSEMBLY (REV. B)